



Rome/Floyd County Building Inspection Department Check List for Single Family Dwellings

We cannot accept or review any application until all items are provided

Address

If you live in Floyd County, contact the Floyd County Engineering Department @ 706-291-5114.
If you live within the city limits, contact the City of Rome Public Works Department @ 706-236-4466.

Driveway Permit

Floyd County residents, to obtain a driveway permit, contact Floyd County Engineering Department located @ 12 E. 4th Avenue, 706-291-5114.

Zoning Verification

This form states the required setbacks for properties located in Rome & Floyd County. The Zoning Office is located @ 607 Broad Street, 706-236-4675 or 236-5025.

Site Plan/Erosion Control Plan

You are required to submit a site plan to show that the selected site complies with provisions of the standard building code. The location of the proposed dwelling must be outlined on the site plan. Also required are setbacks, sediment barriers, and construction entrance locations.

Septic Tank/Sewer Receipt

If your home will be connected to a septic tank, you must provide us with a certificate from the Floyd County Health Department located @ 16 E. 12th Street, 706-295-6316.

If your home will be connected to public sewer, you must provide us with a receipt from the City of Rome Water Billing Office or Floyd County Water Department depending upon your location.

EMAIL TO: jfranks@romegea.us & sroberson@romegea.us

Rome/Floyd County Building Inspection Department
Single Family Dwellings

Date: _____

Project Address: _____

Subdivision: _____

PROPERTY OWNER INFORMATION:

NAME: _____

ADDRESS: _____

CELL PHONE: _____

EMAIL: _____

CONTRACTOR INFORMATION:

NAME: _____

ADDRESS: _____

CELL PHONE: _____

EMAIL: _____

Building Dimensions (Overall): _____ x _____ Number of Stories: _____

Heated Square Feet: _____ Unheated Square Feet: _____

Cost of Construction: _____

Number of Total Rooms: _____ Bedrooms: _____ Baths: _____

Contractor Affidavit

This form must be completed, signed, and submitted to the Rome/Floyd County Inspections Department.

Combination Permit Number _____ Date of Permit Issuance _____

Contractor _____

State Card # _____

Electrical Contractor

Company or Contractor _____

Address _____

State Card # _____ Issued Date _____

Card Holder's Signature _____

Plumbing Contractor

Company or Contractor _____

Address _____

State Card # _____ Issued Date _____

Card Holder's Signature _____

Conditioned Air Contractor

Company or Contractor _____

Address _____

State Card # _____ Issued Date _____

Card Holder's Signature _____

I DO CERTIFY THAT I AM RESPONSIBLE FOR EACH REQUIRED LICENSED CONTRACTOR.
ANY FALSE INFORMATION WILL VOID PERMIT.

X _____

Rome/Floyd County Building Inspection Department 1&2 Family Dwellings Inspection Procedures:

1. Footing Inspection – Prior to concrete placement.
2. Underslab Plumbing Inspection – Test required.
3. Slab Inspection – Prior to concrete placement.
4. Basement Wall Inspection – Prior to concrete placement.
5. Foundation Inspection – Prior to framing.
6. Floor Joist Inspection
7. Sheathing Inspection – Prior to siding
8. Rough-In Inspections – PLG, electrical, HVAC, gas lines, fireplaces.
9. Framing Inspection – After or concurrent with rough-ins.
10. Electrical Meter Inspection – for service.
11. Gas Inspection – for service.
12. Driveway Pipe Inspection.
13. Final Inspections – Concurrently for Certificate of Occupancy.

Policies Regarding Inspections:

1. All inspections require a minimum of 24 hour notice.
2. All inspections shall be scheduled through the Building Inspection office 706-236-4480.
3. When calling in your inspection, you must have the address, permit number, and type of inspection before your inspection is scheduled.
4. Appointments may be scheduled by the inspector after an inspection has been assigned to the inspector and as their schedule will allow. Consideration is given to time sensitive inspections such as electrical changer-overs, footings, slabs, etc.
5. No inspection will be made if erosion control measures are not in place and acceptable. (Re-inspection fee will be required).

Re-inspection fees are currently \$60.00

Rome/Floyd County Building Inspection Department
Required Minimum Building Plans: Single Family Dwelling

Site Plan (Plot Plan)

1. Property Boundary Lines and Adjacent Public Ways (roads, waterways, railways, etc.).
2. Adjacent Property Owners and Uses.
3. Existing Structures and Easements.
4. Location of Proposed Improvements and Minimum Setbacks.
5. Flood Plain Areas; if applicable.

**ROME/FLOYD COUNTY BUILDING INSPECTION DEPARTMENT
EROSION & SEDIMENT CONTROL AFFIDAVIT FOR INDIVIDUAL
ONE & TWO FAMILY RESIDENTAL LOTS**

A BUILDING PERMIT WILL NOT BE ISSUED UNTIL THIS FORM IS COMPLETED

Job Site Address: _____

Property Owner: _____

Owner Address: _____

Owner Phone: _____

General Contractor: _____

Address: _____

Phone: _____

My signature hereto signifies that I am the person responsible for compliance with the Rome/Floyd County Erosion & Control Ordinance for this building project. I hereby acknowledge that proper erosion control measures shall be used on this site which includes as a minimum the following:

1. The most appropriate option, from the second page of this form, is option _____ or a combination of options _____ & _____.
2. Installation and regular maintenance of silt barriers at all points where surface water flows from the building lot; and
3. Installation and regular maintenance of a stone (1.5"-3.5") driveway entrance/exit pad (15' wide x 20' long x 6' deep) to minimize the tracking of mud into the street; and
4. Immediate removal of any accumulation of mud, debris, or sediment from the street; and
5. Conduct no land disturbing activities with 25 feet of the banks of any stream, lake, wetland, or other water body classified as state waters; and
6. Establish temporary vegetation and/or mulch on any disturbed areas upon completion of grading operations.
Lot shall at a minimum be seeded and mulched in or to receive a Certificate of Occupancy.
7. Install other measures as found necessary by onsite inspection by Rome/Floyd County; and
8. Remove and properly dispose of silt fencing once property has adequate ground cover established.

SEE SECOND PAGE FOR STANDARD EROSION CONTROL PLAN & SPECIFICATIONS

I hereby further acknowledge that items 1 & 2 above shall be inspected and approved onsite by building inspection staff prior to or concurrent with any other required inspections. Failure to comply with erosion control requirements may result in the issuance of stop work orders, suspension of all permits and inspections and/or issuance of a citation to appear before Rome Municipal or Floyd County Magistrate Court for failure to comply with erosion control requirement.

Signature

Date

SEDIMENTATION & EROSION CONTROL OPTIONS

INSTRUCTIONS: Identify one or any combination of letters for the sedimentation control schematic that best describes the measures that will be used on this property during construction.

Legend

- ■ ■ ■ ■ Silt Fence
- ▨ Construction Entrance
- ➔ Direction of Flow (Point downhill)
- ▬ Barricade Fence (Such as silt fence, tree protection fence, etc.)

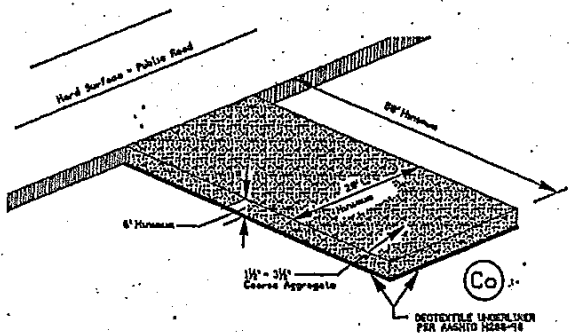
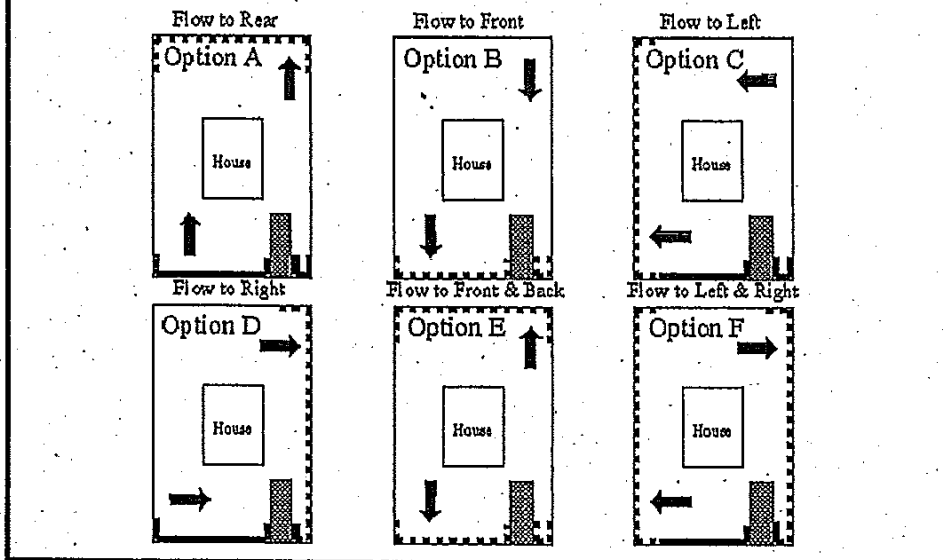

GRAVEL CONSTRUCTION ENTRANCE

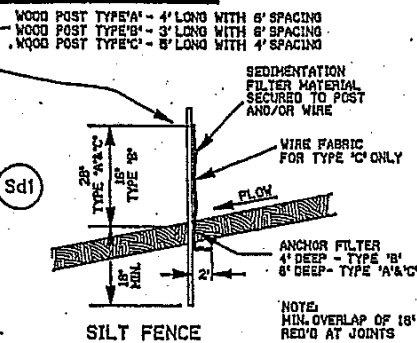

SEDIMENT BARRIERS

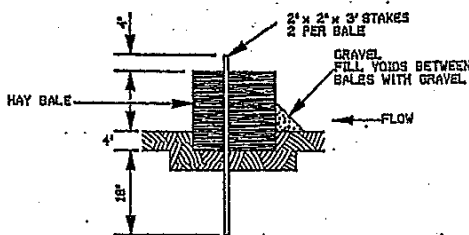

HAY BALE SILT BARRIER

Table 1. Mulching Application Requirements.

Material	Rate	Depth
Straw or hay	2 1/4 Ton/Acre	6" to 10"
Wood waste, chips, sawdust, bark	6 to 9 Ton/Acre	2" to 3"
Cutback asphalt	1200 gal./acre or 1/4 gal./sq. yd.	—
Polyethylene film	Secure with soil, anchors, weights	—
Cutback asphalt	See manufacturer's recommendations	—
Geotextiles, jute matting, netting, etc.	See manufacturer's recommendations	—

Table 2. Some Temporary Plant Species, Seeding Rates and Planting Dates

Species	Rates Per 1,000 sq. ft.	Rates per Acre	Planting Dates by Region		
			M - L	P	C
Rye (Grain)	3.9 lbs.	3 bu.	8/15-11/19	9/15-12/1 3/1-4/1	10/1-11/1
Ryegrass	0.9 lb.	40 lbs.	8/15-11/15	9/1-12/15	9/15-1/1
Rye and Annual Lespedeza	0.6 lb. 0.6 lb.	0.5 bu. 24 lbs.	3/1-4/1	3/1-4/1	2/1-3/1
Weeping Lovegrass	0.1 lb.	4 lbs.	4/1-6/1	4/1-6/1	3/1-6/1
Sudangrass	1 lb.	60 lbs.	5/1-8/1	5/1-8/1	4/1-8/1
Browntop Millet	1.1 lbs.	50 lbs.	4/15-6/15	4/15-7/1	4/15-7/1
Wheat	4.1 lbs.	3 bu.	9/15-12/1	10/1-12/15	10/15-1/1

1. Unusual site conditions may require heavier seeding rates.
2. Seeding dates may need to be altered to fit temperature variations and local conditions.