



## Rome/Floyd County Building Inspection Department Check List for Storage/Garage Building.

\*\*\*We cannot accept or review any application until all items are provided\*\*\*

### Zoning Verification

This form states the required setbacks for properties located in Rome & Floyd County. The Zoning Office is located @ 607 Broad Street, 706-236-4675 or 236-5025.

### Site Plan/Erosion Control Plan

You are required to submit a site plan to show that the selected site complies with provisions of the standard building code. The location of the proposed dwelling must be outlined on the site plan. Also required are setbacks, sediment barriers, and construction entrance locations.

EMAIL TO: [jfranks@romea.us](mailto:jfranks@romea.us) & [sroberson@romea.us](mailto:sroberson@romea.us)



**CITY OF ROME & FLOYD COUNTY  
BUILDING INSPECTION  
PERMIT APPLICATION  
STORAGE OR DETACHED GARAGE BUILDINGS**

**P.O. BOX 1433  
ROME, GA 30161  
PHONE: 706-236-4480**

**PROJECT ADDRESS:** \_\_\_\_\_

**PROPERTY OWNER INFORMATION:**

**NAME:** \_\_\_\_\_

**ADDRESS:** \_\_\_\_\_

**CELL PHONE:** \_\_\_\_\_

**EMAIL:** \_\_\_\_\_

**CONTRACTOR INFORMATION (if different from property owner):**

**NAME:** \_\_\_\_\_

**ADDRESS:** \_\_\_\_\_

**CELL PHONE:** \_\_\_\_\_

**EMAIL:** \_\_\_\_\_

**SQUARE FOOTAGE:** \_\_\_\_\_ X \_\_\_\_\_

**JOB COST:** \_\_\_\_\_

If mailing a check, please send to Building Inspection P.O. Box 1433 Rome, GA 3016

**ROME/FLOYD COUNTY BUILDING INSPECTION DEPARTMENT  
EROSION & SEDIMENT CONTROL AFFIDAVIT FOR INDIVIDUAL  
ONE & TWO FAMILY RESIDENTAL LOTS**

**A BUILDING PERMIT WILL NOT BE ISSUED UNTIL THIS FORM IS COMPLETED**

Job Site Address: \_\_\_\_\_

Property Owner: \_\_\_\_\_

Owner Address: \_\_\_\_\_

Owner Phone: \_\_\_\_\_

General Contractor: \_\_\_\_\_

Address: \_\_\_\_\_

Phone: \_\_\_\_\_

**My signature hereto signifies that I am the person responsible for compliance with the Rome/Floyd County Erosion & Control Ordinance for this building project.** I hereby acknowledge that proper erosion control measures shall be used on this site which includes as a minimum the following:

1. The most appropriate option, from the second page of this form, is option \_\_\_\_\_ or a combination of options \_\_\_\_\_ & \_\_\_\_\_.
2. Installation and regular maintenance of silt barriers at all points where surface water flows from the building lot; and
3. Installation and regular maintenance of a stone (1.5"-3.5") driveway entrance/exit pad (15' wide x 20' long x 6' deep) to minimize the tracking of mud into the street; and
4. Immediate removal of any accumulation of mud, debris, or sediment from the street; and
5. Conduct no land disturbing activities with 25 feet of the banks of any stream, lake, wetland, or other water body classified as state waters; and
6. Establish temporary vegetation and/or mulch on any disturbed areas upon completion of grading operations.  
**Lot shall at a minimum be seeded and mulched in or to receive a Certificate of Occupancy.**
7. Install other measures as found necessary by onsite inspection by Rome/Floyd County; and
8. Remove and properly dispose of silt fencing once property has adequate ground cover established.

**SEE SECOND PAGE FOR STANDARD EROSION CONTROL PLAN & SPECIFICATIONS**

I hereby further acknowledge that items 1 & 2 above shall be inspected and approved onsite by building inspection staff prior to or concurrent with any other required inspections. Failure to comply with erosion control requirements may result in the issuance of stop work orders, suspension of all permits and inspections and/or issuance of a citation to appear before Rome Municipal or Floyd County Magistrate Court for failure to comply with erosion control requirement.

\_\_\_\_\_  
Signature

\_\_\_\_\_  
Date

## SEDIMENTATION & EROSION CONTROL OPTIONS

**INSTRUCTIONS:** Identify one or any combination of letters for the sedimentation control schematic that best describes the measures that will be used on this property during construction.

**Legend**

- ■ ■ ■ ■ Silt Fence
- ▨ Construction Entrance
- ➔ Direction of Flow (Point downhill)
- ▬ Barricade Fence (Such as silt fence, tree protection fence, etc.)

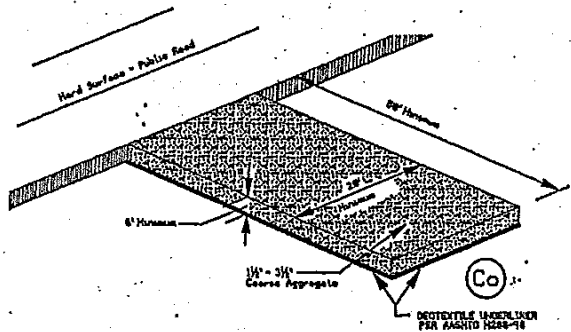
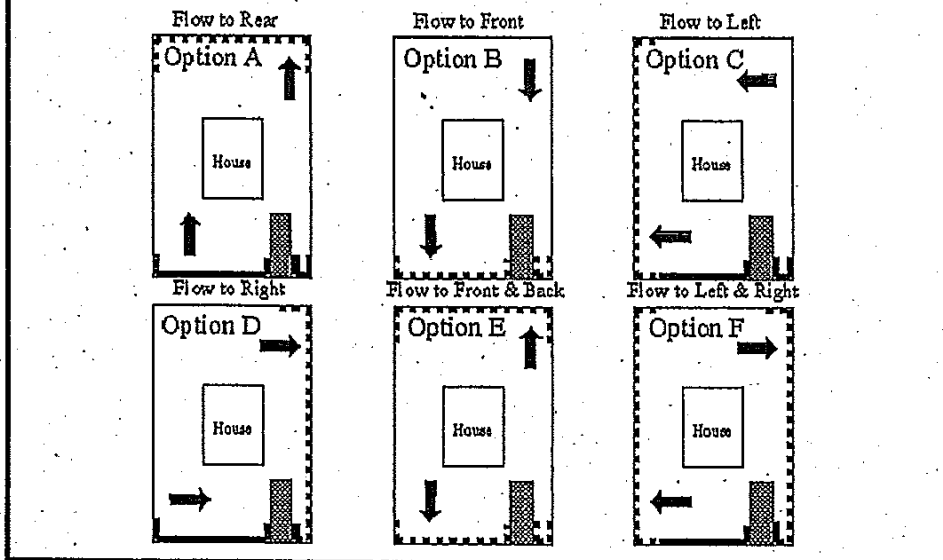

**GRAVEL CONSTRUCTION ENTRANCE**

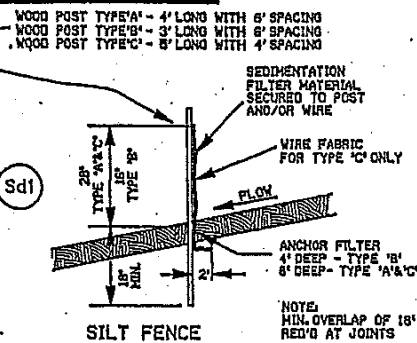

**SEDIMENT BARRIERS**

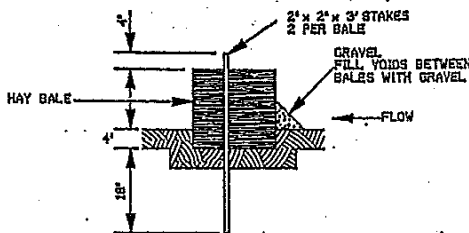

**HAY BALE SILT BARRIER**

**Table 1. Mulching Application Requirements.**

Material	Rate	Depth
Straw or hay	2 1/4 Ton/Acre	6" to 10"
Wood waste, chips, sawdust, bark	6 to 9 Ton/Acre	2" to 3"
Cutback asphalt	1200 gal./acre or 1/4 gal./sq. yd.	—
Polyethylene film	Secure with soil, anchors, weights	—
Cutback asphalt	See manufacturer's recommendations	—
Geotextiles, jute matting, netting, etc.	See manufacturer's recommendations	—

**Table 2. Some Temporary Plant Species, Seeding Rates and Planting Dates**

Species	Rates Per 1,000 sq. ft.	Rates per Acre	Planting Dates by Region		
			M - L	P	C
Rye (Grain)	3.9 lbs.	3 bu.	8/15-11/19	9/15-12/1 3/1-4/1	10/1-11/1
Ryegrass	0.9 lb.	40 lbs.	8/15-11/15	9/1-12/15	9/15-1/1
Rye and Annual Lespedeza	0.6 lb. 0.6 lb.	0.5 bu. 24 lbs.	3/1-4/1	3/1-4/1	2/1-3/1
Weeping Lovegrass	0.1 lb.	4 lbs.	4/1-6/1	4/1-6/1	3/1-6/1
Sudangrass	1 lb.	60 lbs.	5/1-8/1	5/1-8/1	4/1-8/1
Browntop Millet	1.1 lbs.	50 lbs.	4/15-6/15	4/15-7/1	4/15-7/1
Wheat	4.1 lbs.	3 bu.	9/15-12/1	10/1-12/15	10/15-1/1

1. Unusual site conditions may require heavier seeding rates.  
2. Seeding dates may need to be altered to fit temperature variations and local conditions.